

Liquid Tight Conduit Fittings

Cable Accessories

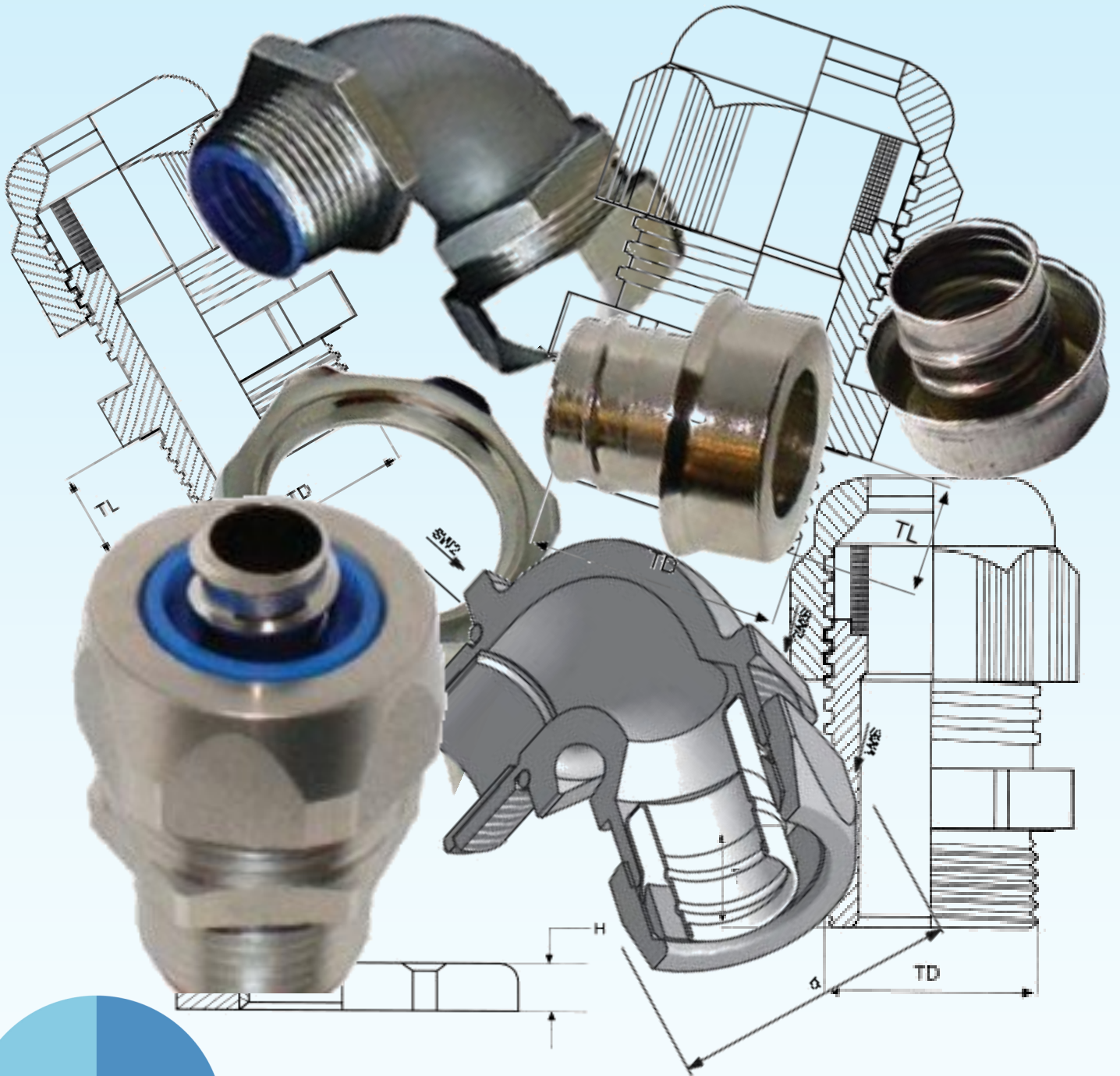

**QUALITY-
FASTER THAN YOU THINK!**

The Company



SAB North America's Stainless Steel and Nickel-Plated Brass Liquid Tight Conduit Fittings lend themselves to applications in environments like food processing, paper mills, refineries, renewable energy, and more. Due to their high corrosive resistant properties, these fittings are useful in industries as diverse as healthcare, offshore mining, food and drink, automation, and more.

The robust construction of all of the liquid tight conduit fittings meets all the UL/CSA requirements. For cable hose fittings, even an IP68 protection can be obtained.

SAB North America utilizes a 4 piece fitting. The construction is fully adapted to the conduit and guarantees an IP67 watertight connection. The use of nickel-plated brass guarantees high corrosion resistance. SAB also uses stainless steel as an alternative construction material. Fittings are available in a large selection range; ISO Metric, PG, and NPT in Straight, 45° and 90° male execution.

SAB North America provides cable solutions that meet, exceed, and set new standards in the cable market. For over 60 years SAB has not only provided our customers with a wide array of wire & cable products on our shelves but also impeccable, unmatched service.

In addition to being a focused supplier of flexible cable products to the automation and robotics industries, SAB proudly offers an extensive inventory and product line of high-quality cable accessories. The Liquid Tight Conduit Fittings complement our flexible control and automation cables perfectly.

To help you identify the best products for your needs, or to request a full line flexible control and automation cable catalog, feel free to contact us at any of the following:

344 Kaplan Drive, Fairfield, NJ 07004

Toll free: 1-866-722-2974 • Phone: 973-276-0500 • Fax: 973-276-1515



LIQUID TIGHT CONDUIT FITTINGS (MALE)

Technical data:

Material	Brass, Nickel Plated
Seal Ring	Polyamide 6 V2
Protection Bushing	Polyamide 6 V2
Ferrule	Brass nickel plated or Steel zinc plated
Protection Class	IP68 - 5 Bar
Oper. Temperature	-45°C to +105°C permanent
O-Ring	NBR
Construction	Piece fitting (counter nut, seal ring, ferrule and body) The counternut and body are made of nickel-plated brass, the ferrule is plated steel (size 3/8" till 1") or nickel plated brass (other sizes). The insert and the sealing are made of Polyamide.

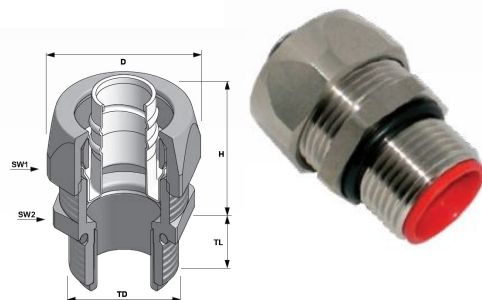

			For sealtite	Max. internal				SW1	SW2
Codes		Size	size	diameter (mm)	H (mm)	TL (mm)	ØD (mm)	(mm)	(mm)
Metric straight fitting (red insert)									
BBFM-01	M20x1,5/M12	M12X1,5	1/4"	5,2	21,5	10,0	24,5	22,0	20,0
BBFM-02	M24x1,5/M16	M16X1,5	5/16"	8,3	23,5	11,5	29,0	26,0	24,0
BBFM-02 (S)	M24x1,5/M16	M16X1,5	3/8"	10,2	23,0	11,5	29,0	26,0	24,0
BBFM-03	M24x1,5/M20	M20X1,5	3/8"	10,2	23,0	13,0	29,0	26,0	24,0
BBFM-03 (S)	M27x1,5/M20	M20X1,5	1/2"	13,5	24,0	13,0	32,7	29,0	27,0
BBFM-04	M33x1,5/M25	M25X1,5	3/4"	18,5	25,0	15,0	38,7	35,0	33,0
BBFM-05	M42x1,5/M32	M32X1,5	1"	23,5	31,5	15,0	50,0	45,0	43,0
BBFM-06	M50x1,5/M40	M40X1,5	1 1/4"	31,8	36,0	16,0	60,0	54,0	52,0
BBFM-07	M58x1,5/M50	M50X1,5	1 1/2"	36,8	38,0	18,0	69,3	63,0	60,0
BBFM-08	M72x2,0/M63	M63X1,5	2"	47,8	45,0	20,0	85,0	77,0	74,0
BBFM-09	M86x2,0/M72	M72X2,0	2 1/2"	61,8	50,0	24,0	105,0	95,0	90,0
BBFM-10	M103x2,0/M80	M80X2,0	3"	70,0	55,0	28,0	122,0	110,0	105
PG straight fitting (blue insert)									
BBFB-01	M20x1,5/Pg7	7	1/4"	5,2	22,0	10,0	24,5	22,0	20,0
BBFB-02	M20x1,5/Pg9	9	1/4"	5,2	25,5	10,0	24,5	22,0	20,0
BBFB-02 (A)	M20x1,5/Pg9	9	5/16"	8,3	25,5	10,0	24,5	22,0	20,0
BBFB-02 (B)	M24x1,5/Pg9	9	5/16"	8,3	23,0	11,5	29,0	26,0	24,0
BBFB-02 (C)	M24x1,5/Pg9	9	3/8"	10,2	23,0	11,5	29,0	26,0	24,0
BBFB-03	M24x1,5/Pg11	11	3/8"	10,2	23,0	11,5	29,0	26,0	24,0
BBFB-04	M24x1,5/Pg13,5	13,5	3/8"	10,2	23,0	11,5	29,0	26,0	24,0
BBFB-05	M27x1,5/Pg16	16	1/2"	13,5	24,0	13,0	32,7	29,0	27,0
BBFB-06	M33x1,5/Pg21	21	3/4"	18,5	25,5	15,0	38,7	35,0	33,0
BBFB-07	M42x1,5/Pg29	29	1"	23,5	31,5	15,0	50,0	45,0	43,0
BBFB-08	M50x1,5/Pg36	36	1 1/4"	31,8	36,0	16,0	60,0	54,0	52,0
BBFB-09	M58x1,5/Pg42	42	1 1/2"	36,8	38,5	18,0	69,3	63,0	60,0
BBFB-10	M72x2,0/Pg48	48	2"	47,8	45,0	20,0	85,0	77,0	74,0
NPT straight fitting (white insert)									
BBFN-0S	M20x1,5/Npt1/4	1/4"	1/4"	5,2	24,0	10,0	24,5	22,0	20,0
BBFN-0S (S)	M20x1,5/Npt3/8	3/8"	3/8"	10,2	24,0	10,0	24,5	22,0	20,0
BBFN-01	M24x1,5/Npt1/2	1/2"	5/16"	8,3	23,5	13,0	29,0	26,0	24,0
BBFN-02	M24x1,5/Npt1/2	1/2"	3/8"	10,2	23,0	13,0	29,0	26,0	24,0
BBFN-02 (S)	M27x1,5/Npt1/2	1/2"	1/2"	13,6	23,5	13,0	32,7	29,0	27,0
BBFN-03	M33x1,5/Npt3/4	3/4"	3/4"	18,5	25,5	15,0	38,7	35,0	33,0
BBFN-04	M42x1,5/Npt1	1"	1"	23,5	31,5	15,0	50,0	45,0	43,0
BBFN-05	M50x1,5/Npt5/4	1 1/4"	1 1/4"	31,8	36,0	16,0	60,0	54,0	52,0
BBFN-06	M58x1,5/Npt3/2	1 1/2"	1 1/2"	36,8	38,0	18,0	69,3	63,0	60,0
BBFN-07	M72x2,0/Npt2	2"	2"	47,8	44,5	20,0	85,0	77,0	74,0

1

Various colors, materials, and sizes available upon request

Email: info@sabcable.com



Website: www.sabcable.com

LIQUID TIGHT CONDUIT FITTINGS (MALE)

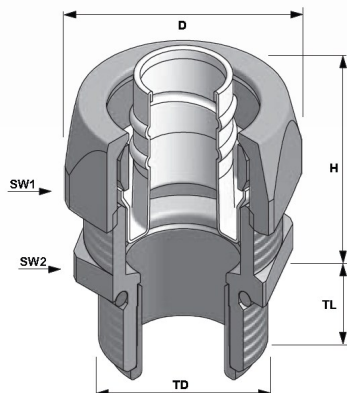

Technical data:

Material	Stainless Steel AISI 303
Seal Ring	Polyamide 6 V2
Protection Bushing	Polyamide 6 V2
Ferrule	Brass nickel plated or Steel zinc plated
Protection Class	IP68 - 5 Bar
Oper. Temperature	-45°C to +105°C permanent
O-Ring	NBR
Construction	Piece fitting (counter nut, seal ring, ferrule and body) The counternut and body are made of Stainless steel, the ferrule is plated steel (size 3/8" till 1") or nickel plated brass (other sizes). The insert and the sealing are made of Polyamide.

Codes	Size	For sealtite size	Max. internal diameter (mm)	H (mm)	TL (mm)	ØD (mm)	SW1 (mm)	SW2 (mm)
Metric straight fitting (red insert)								
BBFM-02 (S) SS	M24x1,5/M16	M16X1,5 5/16"	8,3	23,5	11,5	30,0	27,0	24,0
BBFM-03 (SP) SS	M24x1,5/M20	M20X1,5 5/16"	8,3	23,0	13,0	30,0	27,0	24,0
BBFM-02 SS	M24x1,5/M16	M16X1,5 3/8"	10,9	22,5	11,5	30,0	27,0	24,0
BBFM-03 (S) SS	M27x1,5/M20	M20X1,5 3/8"	10,9	22,5	13,0	30,0	27,0	24,0
BBFM-03 SS	M27x1,5/M20	M20X1,5 1/2"	13,9	22,5	13,0	33,7	30,0	27,0
BBFM-04 SS	M33x1,5/M25	M25X1,5 3/4"	18,9	24,0	15,0	39,7	36,0	36,0
BBFM-05 SS	M42x1,5/M32	M32X1,5 1"	24,4	30,0	15,0	51,0	46,0	46,0
BBFM-06 SS	M50x1,5/M40	M40X1,5 1 1/4"	31,8	35,5	16,0	60,0	54,0	52,0
PG straight fitting (blue insert)								
BBFB-01 SS	M20x1,5/Pg7	7 1/4"	5,2	22,0	10,0	25,0	22,0	20,0
BBFB-02 SS	M20x1,5/Pg9	9 5/16"	8,3	24,0	11,5	30,0	26,0	24,0
BBFB-03 SS	M24x1,5/Pg11	11 3/8"	10,2	23,0	11,5	30,0	26,0	24,0
BBFB-04 SS	M24x1,5/Pg13,5	13,5 3/8"	10,2	23,0	11,5	30,0	26,0	24,0
BBFB-05 SS	M27x1,5/Pg16	16 1/2"	13,5	24,0	13,0	33,7	29,0	27,0
BBFB-06 SS	M33x1,5/Pg21	21 3/4"	18,5	25,5	15,0	39,7	35,0	33,0
BBFB-07 SS	M42x1,5/Pg29	29 1"	23,5	31,5	15,0	51,0	45,0	43,0
BBFB-08 SS	M50x1,5/Pg36	36 1 1/4"	31,8	36,0	16,0	60,0	54,0	52,0
BBFB-09 SS	M58x1,5/Pg42	42 1 1/2"	36,8	38,5	18,0	69,3	63,0	60,0
BBFB-10 SS	M72x2,0/Pg48	48 2"	47,8	45,0	20,0	85,0	77,0	74,0
NPT straight fitting (white insert)								
BBFN-02 (S) SS	M24x1,5/Npt1/2	1/2" 3/8"	10,9	22,0	13,0	30,0	27,0	24,0
BBFN-02 SS	M27x1,5/Npt1/2	1/2" 1/2"	13,9	23,0	13,0	33,7	30,0	27,0
BBFN-03 SS	M33x1,5/Npt3/4	3/4" 3/4"	18,9	24,0	15,0	39,7	36,0	36,0
BBFN-04 SS	M42x1,5/Npt1	1" 1"	24,4	30,0	15,0	51,0	46,0	46,0

LIQUID TIGHT CONDUIT FITTINGS (45°)

Technical data:

Material	Brass, Nickel Plated
Seal Ring	Polyamide 6 V2
Protection Bush-	Polyamide 6 V2
Ferrule	Brass nickel plated or Steel zinc plated
Protection Class	IP68 - 5 Bar
Oper. Temperature	-45°C to +105°C permanent
O-Ring	NBR
Construction	Piece fitting (counter nut, seal ring, ferrule and body) The counter nut and body are made of nickel-plated brass, the ferrule is plated steel (size 3/8" till 1") or nickel plated brass (other sizes). The insert and the sealring are made of Polyamide.

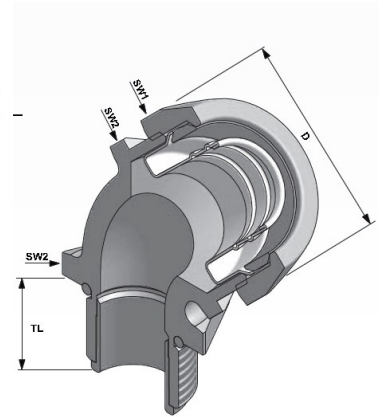

Codes	Size	For sealtite size	Max. internal diameter (mm)	TL (mm)	ØD (mm)	SW1 (mm)	SW2 (mm)
Metric 45° fitting (red insert)							
BBFM-02 (S) 45	M24x1,5/M16	M16X1,5	5/16"	8,3	11,5	29,0	26,0
BBFM-02 45	M24x1,5/M16	M16X1,5	3/8"	10,2	11,5	29,0	26,0
BBFM-03 (S) 45	M24x1,5/M20	M20X1,5	3/8"	10,2	13,0	29,0	26,0
BBFM-03 45	M27x1,5/M20	M20X1,6	1/2"	13,5	13,0	32,7	29,0
BBFM-04 45	M33x1,5/M25	M25X1,5	3/4"	18,5	15,0	38,7	35,0
BBFM-05 45	M42x1,5/M32	M32X1,5	1"	23,5	15,0	50,0	45,0
BBFM-06 45	M50x1,5/M40	M40X1,5	1 1/4"	31,8	16,0	60,0	54,0
BBFM-07 45	M58x1,5/M50	M50X1,5	1 1/2"	36,8	18,0	69,3	63,0
BBFM-08 45	M72x2,0/M63	M63X1,5	2"	47,8	20,0	85,0	77,0
PG 45° fitting (blue insert)							
BBFB-03 (S) 45	M24x1,5/Pg11	11	5/16"	8,3	11,5	29,0	26,0
BBFB-03 45	M24x1,5/Pg11	11	3/8"	10,2	11,5	29,0	26,0
BBFB-04 45	M24x1,5/Pg13,5	13,5	3/8"	10,2	11,5	29,0	26,0
BBFB-05 45	M27x1,5/Pg16	16	1/2"	13,5	13,0	32,7	29,0
BBFB-06 45	M33x1,5/Pg21	21	3/4"	18,5	15,0	38,7	35,0
BBFB-07 45	M42x1,5/Pg29	29	1"	23,5	15,0	50,0	45,0
BBFB-08 45	M50x1,5/Pg36	36	1 1/4"	31,8	16,0	60,0	54,0
BBFB-09 45	M58x1,5/Pg42	42	1 1/2"	36,8	18,0	69,3	63,0
BBFB-10 45	M72x2,0/Pg48	48	2"	47,8	20,0	85,0	77,0
NPT 45° fitting (white insert)							
BBFN-01 45	M24x1,5/Npt1/2	1/2"	5/16"	8,3	13,0	29,0	26,0
BBFN-02 (S) 45	M24x1,5/Npt1/2	1/2"	3/8"	10,2	13,0	29,0	26,0
BBFN-02 45	M27x1,5/Npt1/2	1/2"	1/2"	13,5	13,0	32,7	29,0
BBFN-03 45	M33x1,5/Npt3/4	3/4"	3/4"	18,5	15,0	38,7	35,0
BBFN-04 45	M42x1,5/Npt1	1"	1"	23,5	15,0	50,0	45,0
BBFN-05 45	M50x1,5/Npt5/4	1 1/4"	1 1/4"	31,8	16,0	60,0	54,0
BBFN-06 45	M58x1,5/Npt3/2	1 1/2"	1 1/2"	36,8	18,0	69,3	63,0
BBFN-07 45	M72x2,0/Npt2	2"	2"	47,8	20,0	85,0	77,0

3

Various colors, materials, and sizes available upon request

Email: info@sabcable.com



Website: www.sabcable.com

LIQUID TIGHT CONDUIT FITTINGS (45°)

Technical data:

Material	Stainless Steel AISI 303
Seal Ring	Polyamide 6 V2
Protection Bushing	Polyamide 6 V2
Ferrule	Brass nickel plated or Steel zinc plated
Protection Class	IP68 - 5 Bar
Oper. Temperature	-45°C to +105°C permanent
O-Ring	NBR
Construction	Piece fitting (counter nut, seal ring, ferrule and body) The counternut and body are made of Stainless steel, the ferrule is plated steel (size 3/8" till 1") or nickel plated brass (other sizes). The insert and the sealring are made of Polyamide.

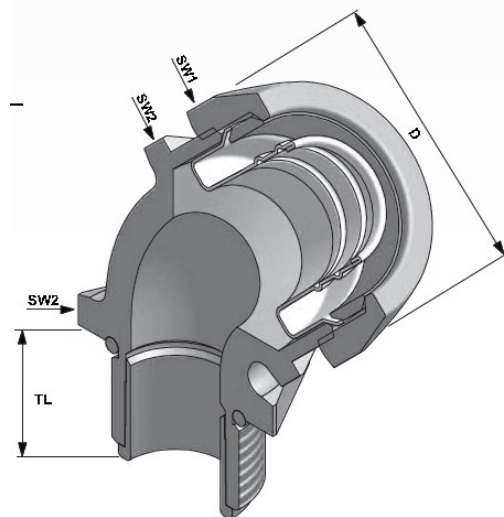

Codes	Size	For sealtite size	Max. internal diameter (mm)	TL (mm)	ØD (mm)	SW1 (mm)	SW2 (mm)
Metric 45° fitting (red insert)							
BBFM-02 (S) 45 SS	M24x1,5/M16	M16X1,5	5/16"	8,3	11,5	30,0	27,0
BBFM-02 45 SS	M24x1,5/M16	M16X1,5	3/8"	10,9	11,5	30,0	27,0
BBFM-03 45 SS	M27x1,5/M20	M20X1,5	1/2"	13,9	13,0	33,7	30,0
BBFM-04 45 SS	M33x1,5/M25	M25X1,5	3/4"	18,9	15,0	39,7	36,0
PG 45° fitting (blue insert)							
BBFB-03 (S) 45 SS	M24x1,5/Pg11	11	5/16"	8,3	11,5	30,0	26,0
BBFB-03 45 SS	M24x1,5/Pg11	11	3/8"	10,2	11,5	30,0	26,0
BBFB-04 45 SS	M24x1,5/Pg13,5	13,5	3/8"	10,2	11,5	30,0	26,0
BBFB-05 45 SS	M27x1,5/Pg16	16	1/2"	13,5	13,0	33,7	29,0
BBFB-06 45 SS	M33x1,5/Pg21	21	3/4"	18,5	15,0	39,7	35,0
BBFB-07 45 SS	M42x1,5/Pg29	29	1"	23,5	15,0	51,0	45,0
BBFB-08 45 SS	M50x1,5/Pg36	36	1 1/4"	31,8	16,0	60,0	54,0
BBFB-09 45 SS	M58x1,5/Pg42	42	1 1/2"	36,8	18,0	69,3	63,0
BBFB-10 45 SS	M72x2,0/Pg48	48	2"	47,8	20,0	85,0	77,0
NPT 45° fitting (white insert)							
BBFN-02 (S) 45 SS	M24x1,5/Npt1/2	1/2"	3/8"	10,2	13,0	30,0	26,0
BBFN-02 45 SS	M27x1,5/Npt1/2	1/2"	1/2"	13,9	13,0	33,7	30,0
BBFN-03 45 SS	M33x1,5/Npt3/4	3/4"	3/4"	18,9	15,0	39,7	36,0

LIQUID TIGHT CONDUIT FITTINGS (90°)

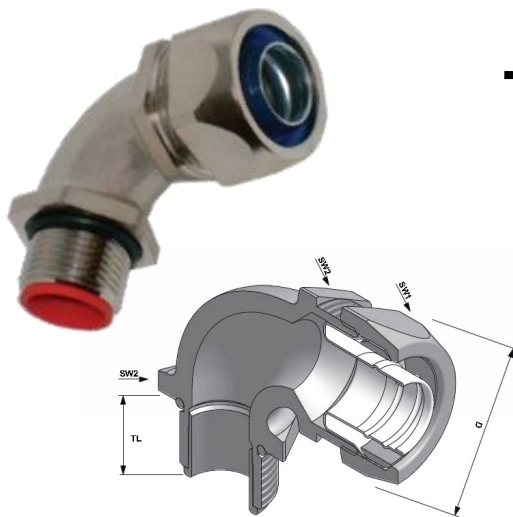

Technical data:

Material	Brass, Nickel Plated
Seal Ring	Polyamide 6 V2
Protection Bushing	Polyamide 6 V2
Ferrule	Brass nickel plated or Steel zinc plated
Protection Class	IP68 - 5 Bar
Oper. Temperature	-45°C to +105°C permanent
O-Ring	NBR
Construction	Piece fitting (counter nut, seal ring, ferrule and body) The counternut and body are made of nickel-plated brass, the ferrule is plated steel (size 3/8" till 1") or nickel plated brass (other sizes). The insert and the sealing are made of Polyamide.

Codes	Size	For sealtite size	Max. internal diameter (mm)	TL (mm)	ØD (mm)	SW1 (mm)	SW2 (mm)
Metric 90° fitting (red insert)							
BBFM-02 (S) 90	M24x1,5/M16	M16X1,5	5/16"	8,3	11,5	29,0	26,0
BBFM-02 90	M24x1,5/M16	M16X1,5	3/8"	10,2	11,5	29,0	26,0
BBFM-03 (S) 90	M24x1,5/M20	M20X1,5	3/8"	10,2	13,0	29,0	26,0
BBFM-03 90	M27x1,5/M20	M20X1,6	1/2"	13,5	13,0	32,7	29,0
BBFM-04 90	M33x1,5/M25	M25X1,5	3/4"	18,5	15,0	38,7	35,0
BBFM-05 90	M42x1,5/M32	M32X1,5	1"	23,5	15,0	50,0	45,0
BBFM-06 90	M50x1,5/M40	M40X1,5	1 1/4"	31,8	16,0	60,0	54,0
BBFM-07 90	M58x1,5/M50	M50X1,5	1 1/2"	36,8	18,0	69,3	63,0
BBFM-08 90	M72x2,0/M63	M63X1,5	2"	47,8	20,0	85,0	77,0
PG 90° fitting (blue insert)							
BBFB-03 (S) 90	M24x1,5/Pg11	11	5/16"	8,3	11,5	29,0	26,0
BBFB-03 90	M24x1,5/Pg11	11	3/8"	10,2	11,5	29,0	26,0
BBFB-04 90	M24x1,5/Pg13,5	13,5	3/8"	10,2	11,5	29,0	26,0
BBFB-05 90	M27x1,5/Pg16	16	1/2"	13,5	13,0	32,7	29,0
BBFB-06 90	M33x1,5/Pg21	21	3/4"	18,5	15,0	38,7	35,0
BBFB-07 90	M42x1,5/Pg29	29	1"	23,5	15,0	50,0	45,0
BBFB-08 90	M50x1,5/Pg36	36	1 1/4"	31,8	16,0	60,0	54,0
BBFB-09 90	M58x1,5/Pg42	42	1 1/2"	36,8	18,0	69,3	63,0
BBFB-10 90	M72x2,0/Pg48	48	2"	47,8	20,0	85,0	77,0
NPT 90° fitting (white insert)							
BBFN-01 90	M24x1,5/Npt1/2	1/2"	5/16"	8,3	13,0	29,0	26,0
BBFN-02 (S) 90	M24x1,5/Npt1/2	1/2"	3/8"	10,2	13,0	29,0	26,0
BBFN-02 90	M27x1,5/Npt1/2	1/2"	1/2"	13,5	13,0	32,7	29,0
BBFN-03 90	M33x1,5/Npt3/4	3/4"	3/4"	18,5	15,0	38,7	35,0
BBFN-04 90	M42x1,5/Npt1	1"	1"	23,5	15,0	50,0	45,0
BBFN-05 90	M50x1,5/Npt5/4	1 1/4"	1 1/4"	31,8	16,0	60,0	54,0
BBFN-06 90	M58x1,5/Npt3/2	1 1/2"	1 1/2"	36,8	18,0	69,3	63,0
BBFN-07 90	M72x2,0/Npt2	2"	2"	47,8	20,0	85,0	77,0

5

Various colors, materials, and sizes available upon request

Email: info@sabcable.com



Continued on next page

Website: www.sabcable.com

LIQUID TIGHT CONDUIT FITTINGS (90°)

Technical data:

Material	Stainless Steel AISI 303
Seal Ring	Polyamide 6 V2
Protection Bushing	Polyamide 6 V2
Ferrule	Brass nickel plated or Steel zinc plated
Protection Class	IP68 - 5 Bar
Oper. Temperature	-45°C to +105°C permanent
O-Ring	NBR
Construction	Piece fitting (counter nut, seal ring, ferrule and body) The counternut and body are made of Stainless steel, the ferrule is plated steel (size 3/8" till 1") or nickel plated brass (other sizes). The insert and the sealing are made of Polyamide.

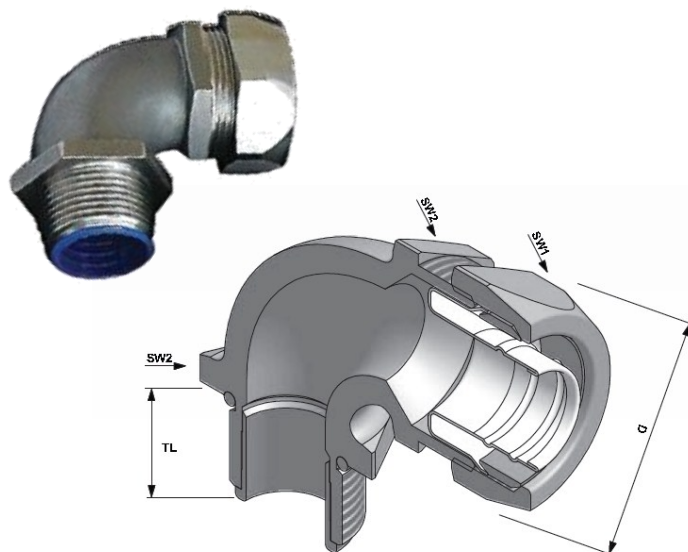

Codes		Size	For seal	Max. internal titediameter size (mm)	TL (mm)	ØD (mm)	SW1 (mm)	SW2 (mm)
Metric 90° fitting (red insert)								
BBFM-02 (S) 90 SS	M24x1,5/M16	M16X1,5	5/16"	8,3	11,5	30,0	27,0	22,0
BBFM-02 90 SS	M24x1,5/M16	M16X1,5	3/8"	10,9	11,5	30,0	27,0	22,0
BBFM-03 90 SS	M27x1,5/M20	M20X1,5	1/2"	13,9	13,0	33,7	30,0	27,0
BBFM-04 90 SS	M33x1,5/M25	M25X1,5	3/4"	18,9	15,0	39,7	36,0	33,0
PG 90° fitting (blue insert)								
BBFB-03 (S) 90 SS	M24x1,5/Pg11	11	5/16"	8,3	11,5	30,0	26,0	22,0
BBFB-03 90 SS	M24x1,5/Pg11	11	3/8"	10,2	11,5	30,0	26,0	22,0
BBFB-04 90 SS	M24x1,5/Pg13,5	13,5	3/8"	10,2	11,5	30,0	26,0	22,0
BBFB-05 90 SS	M27x1,5/Pg16	16	1/2"	13,5	13,0	33,7	29,0	27,0
BBFB-06 90 SS	M33x1,5/Pg21	21	3/4"	18,5	15,0	39,7	35,0	33,0
BBFB-07 90 SS	M42x1,5/Pg29	29	1"	23,5	15,0	51,0	45,0	42,0
BBFB-08 90 SS	M50x1,5/Pg36	36	1 1/4"	31,8	16,0	60,0	54,0	51,0
BBFB-09 90 SS	M58x1,5/Pg42	42	1 1/2"	36,8	18,0	69,3	63,0	60,0
BBFB-10 90 SS	M72x2,0/Pg48	48	2"	47,8	20,0	85,0	77,0	74,0
NPT 90° fitting (white insert)								
BBFN-02 (S) 90 SS	M24x1,5/Npt1/2	1/2"	3/8"	10,2	13,0	30,0	26,0	27,0
BBFN-02 90 SS	M27x1,5/Npt1/2	1/2"	1/2"	13,9	13,0	33,7	30,0	27,0
BBFN-03 90 SS	M33x1,5/Npt3/4	3/4"	3/4"	18,9	15,0	39,7	36,0	33,0

LIQUID TIGHT CONDUIT FITTINGS (FEMALE)

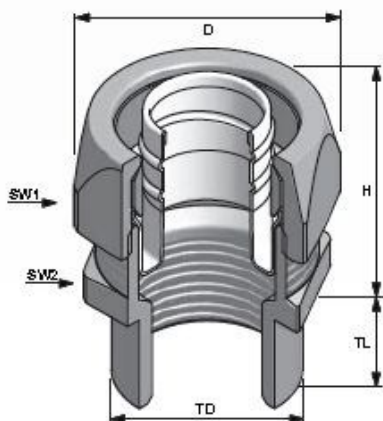

Technical data:

Material	Brass, Nickel Plated
Seal Ring	Polyamide 6 V2
Protection Bushing	Polyamide 6 V2
Ferrule	Brass nickel plated or Steel zinc plated
Protection Class	IP68 - 5 Bar
Oper. Temperature	-45°C to +105°C permanent
O-Ring	NBR
Construction	Piece fitting (counter nut, seal ring, ferrule and body) The counternut and body are made of nickel-plated brass, the ferrule is plated steel (size 3/8" till 1") or nickel plated brass (other sizes). The insert and the sealing are made of Polyamide.

Codes	Size	For sealtite size	Max. internal diameter (mm)	H (mm)	TL (mm)	ØD (mm)	SW1 (mm)	SW2 (mm)
Metric female fitting (red insert)								
BBFM-02 (S) F	M24x1,5/M16	M16X1,5 5/16"	8,3	24,5	11,5	29,0	26,0	24,0
BBFM-02 F	M24x1,5/M16	M16X1,5 3/8"	10,2	23,5	11,5	29,0	26,0	24,0
BBFM-03 F	M27x1,5/M20	M20X1,5 1/2"	13,5	24,0	13,0	32,7	29,0	27,0
BBFM-04 F	M33x1,5/M25	M25X1,5 3/4"	18,5	25,0	15,0	38,7	35,0	33,0
BBFM-05 F	M42x1,5/M32	M32X1,5 1"	23,5	31,5	15,0	50,0	45,0	43,0
BBFM-06 F	M50x1,5/M40	M40X1,5 1 1/4"	31,8	36,0	16,0	60,0	54,0	52,0
BBFM-07 F	M58x1,5/M50	M50X1,5 1 1/2"	36,8	38,5	18,0	69,3	63,0	60,0
BBFM-08 F	M72x2,0/M63	M63X1,5 2"	47,8	46,0	20,0	85,0	77,0	74,0
PG female fitting (blue insert)								
BBFB-03 (S) F	M24x1,5/Pg11	11 5/16"	8,3	24,5	11,5	29,0	26,0	24,0
BBFB-03 F	M24x1,5/Pg11	11 3/8"	10,9	23,0	11,5	29,0	26,0	24,0
BBFB-04 F	M24x1,5/Pg13,5	13,5 3/8"	10,9	25,0	11,5	29,0	26,0	24,0
BBFB-05 F	M27x1,5/Pg16	16 1/2"	13,5	27,0	13,0	32,7	29,0	27,0
BBFB-06 F	M33x1,5/Pg21	21 3/4"	18,5	30,0	16,0	38,7	35,0	33,0
BBFB-07 F	M42x1,5/Pg29	29 1"	23,5	34,0	20,0	50,0	45,0	43,0
BBFB-08 F	M50x1,5/Pg36	36 1 1/4"	31,8	36,0	16,0	60,0	54,0	52,0
BBFB-09 F	M58x1,5/Pg42	42 1 1/2"	36,8	38,5	18,0	69,3	63,0	60,0
BBFB-10 F	M72x2,0/Pg48	48 2"	47,8	46,0	20,0	85,0	77,0	74,0
NPT female fitting (white insert)								
BBFN-01 F	M24x1,5/Npt1/2	1/2" 5/16"	8,3	24,0	13,0	29,0	26,0	24,0
BBFN-02 (S) F	M24x1,5/Npt1/2	1/2" 3/8"	10,9	22,5	13,0	29,0	26,0	24,0
BBFN-02 F	M27x1,5/Npt1/2	1/2" 1/2"	13,5	24,0	13,0	32,7	29,0	27,0
BBFN-03 F	M33x1,5/Npt3/4	3/4" 3/4"	18,5	25,0	15,0	38,7	35,0	33,0
BBFN-04 F	M42x1,5/Npt1	1" 1"	23,5	31,0	15,0	50,0	45,0	43,0
BBFN-05 F	M50x1,5/Npt5/4	1 1/4" 1 1/4"	31,8	35,5	16,0	60,0	54,0	52,0
BBFN-06 F	M58x1,5/Npt3/2	1 1/2" 1 1/2"	36,8	38,0	18,0	69,3	63,0	60,0
BBFN-07 F	M72x2,0/Npt2	2" 2"	47,8	44,5	20,0	85,0	77,0	74,0

7

Various colors, materials, and sizes available upon request

Email: info@sabcable.com



Website: www.sabcable.com

FURRULES (BRASS NICKEL PLATED)

Technical data:

Material

:Brass Nickel Plated or Steel Zinc Plated Codes

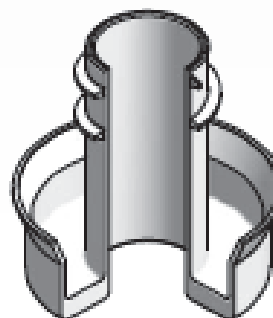

Codes	For Sealtite Size (")	Max. Internal Diameter (mm)
FER-01	1/4"	5,2
FER-02	5/16"	8,3
FER-03	3/8"	10,2
FER-04	1/2"	13,5
FER-05	3/4"	18,5
FER-06	1"	23,5
FER-07	1 1/4"	31,8
FER-08	1 1/2"	36,8
FER-09	2"	47,8
FER-10	2 1/2"	59,1



STRAIGHT SWIVEL FITTINGS

Technical data:

Material	Brass Nickel Plated or Stainless Steel AISI 303
Attachment thread	EN 60423

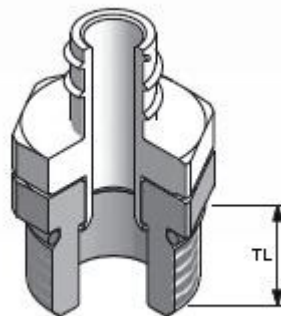

Codes	Size	Description	TL (mm)
BMSSW-0S	M12	Straight Swivel fitting for 1/4" Conduit	8
BMSSW-01	M16	Straight Swivel fitting for 1/4" Conduit	10





344 Kaplan Drive

Fairfield, NJ 07004

Toll Free: 866-722-2974 • Tel: 973-276-0500 • Fax: 973-276-1515

Email: info@sabcable.com • Website: www.sabcable.com