

LIQUID TIGHT CONDUIT FITTINGS (MALE)

Technical data:

Material	Brass, Nickel Plated
Seal Ring	Polyamide 6 V2
Protection Bushing	Polyamide 6 V2
Ferrule	Brass nickel plated or Steel zinc plated
Protection Class	IP68 - 5 Bar
Oper. Temperature	-45°C to +105°C permanent
O-Ring	NBR
Construction	Piece fitting (counter nut, seal ring, ferrule and body) The counternut and body are made of nickel-plated brass, the ferrule is plated steel (size 3/8" till 1") or nickel plated brass (other sizes). The insert and the sealing are made of Polyamide.

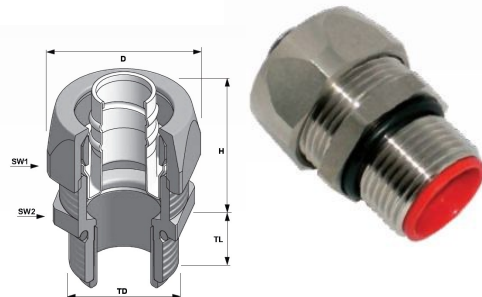

Codes	Size	For sealtite size	Max. internal diameter (mm)	H (mm)	TL (mm)	ØD (mm)	SW1 (mm)	SW2 (mm)	
Metric straight fitting (red insert)									
BBFM-01	M20x1,5/M12	M12X1,5	1/4"	5,2	21,5	10,0	24,5	22,0	20,0
BBFM-02	M24x1,5/M16	M16X1,5	5/16"	8,3	23,5	11,5	29,0	26,0	24,0
BBFM-02 (S)	M24x1,5/M16	M16X1,5	3/8"	10,2	23,0	11,5	29,0	26,0	24,0
BBFM-03	M24x1,5/M20	M20X1,5	3/8"	10,2	23,0	13,0	29,0	26,0	24,0
BBFM-03 (S)	M27x1,5/M20	M20X1,5	1/2"	13,5	24,0	13,0	32,7	29,0	27,0
BBFM-04	M33x1,5/M25	M25X1,5	3/4"	18,5	25,0	15,0	38,7	35,0	33,0
BBFM-05	M42x1,5/M32	M32X1,5	1"	23,5	31,5	15,0	50,0	45,0	43,0
BBFM-06	M50x1,5/M40	M40X1,5	1 1/4"	31,8	36,0	16,0	60,0	54,0	52,0
BBFM-07	M58x1,5/M50	M50X1,5	1 1/2"	36,8	38,0	18,0	69,3	63,0	60,0
BBFM-08	M72x2,0/M63	M63X1,5	2"	47,8	45,0	20,0	85,0	77,0	74,0
BBFM-09	M86x2,0/M72	M72X2,0	2 1/2"	61,8	50,0	24,0	105,0	95,0	90,0
BBFM-10	M103x2,0/M80	M80X2,0	3"	70,0	55,0	28,0	122,0	110,0	105
PG straight fitting (blue insert)									
BBFB-01	M20x1,5/Pg7	7	1/4"	5,2	22,0	10,0	24,5	22,0	20,0
BBFB-02	M20x1,5/Pg9	9	1/4"	5,2	25,5	10,0	24,5	22,0	20,0
BBFB-02 (A)	M20x1,5/Pg9	9	5/16"	8,3	25,5	10,0	24,5	22,0	20,0
BBFB-02 (B)	M24x1,5/Pg9	9	5/16"	8,3	23,0	11,5	29,0	26,0	24,0
BBFB-02 (C)	M24x1,5/Pg9	9	3/8"	10,2	23,0	11,5	29,0	26,0	24,0
BBFB-03	M24x1,5/Pg11	11	3/8"	10,2	23,0	11,5	29,0	26,0	24,0
BBFB-04	M24x1,5/Pg13,5	13,5	3/8"	10,2	23,0	11,5	29,0	26,0	24,0
BBFB-05	M27x1,5/Pg16	16	1/2"	13,5	24,0	13,0	32,7	29,0	27,0
BBFB-06	M33x1,5/Pg21	21	3/4"	18,5	25,5	15,0	38,7	35,0	33,0
BBFB-07	M42x1,5/Pg29	29	1"	23,5	31,5	15,0	50,0	45,0	43,0
BBFB-08	M50x1,5/Pg36	36	1 1/4"	31,8	36,0	16,0	60,0	54,0	52,0
BBFB-09	M58x1,5/Pg42	42	1 1/2"	36,8	38,5	18,0	69,3	63,0	60,0
BBFB-10	M72x2,0/Pg48	48	2"	47,8	45,0	20,0	85,0	77,0	74,0
NPT straight fitting (white insert)									
BBFN-0S	M20x1,5/Npt1/4	1/4"	1/4"	5,2	24,0	10,0	24,5	22,0	20,0
BBFN-0S (S)	M20x1,5/Npt3/8	3/8"	3/8"	10,2	24,0	10,0	24,5	22,0	20,0
BBFN-01	M24x1,5/Npt1/2	1/2"	5/16"	8,3	23,5	13,0	29,0	26,0	24,0
BBFN-02	M24x1,5/Npt1/2	1/2"	3/8"	10,2	23,0	13,0	29,0	26,0	24,0
BBFN-02 (S)	M27x1,5/Npt1/2	1/2"	1/2"	13,6	23,5	13,0	32,7	29,0	27,0
BBFN-03	M33x1,5/Npt3/4	3/4"	3/4"	18,5	25,5	15,0	38,7	35,0	33,0
BBFN-04	M42x1,5/Npt1	1"	1"	23,5	31,5	15,0	50,0	45,0	43,0
BBFN-05	M50x1,5/Npt5/4	1 1/4"	1 1/4"	31,8	36,0	16,0	60,0	54,0	52,0
BBFN-06	M58x1,5/Npt3/2	1 1/2"	1 1/2"	36,8	38,0	18,0	69,3	63,0	60,0
BBFN-07	M72x2,0/Npt2	2"	2"	47,8	44,5	20,0	85,0	77,0	74,0

1

Various colors, materials, and sizes available upon request

Email: info@sabcable.com



Website: www.sabcable.com